

**NOTE: PLEASE VERIFY ALL HEAD AND SILL HEIGHTS. VPI defines the Rough Opening (RO) as the clear opening after all installation and waterproofing materials are applied. It is critical that the RO is a minimum of 1/2" larger than the net window frame size for nail flange applications. In the event that your VPI product will be installed with strap anchors, the RO must be 1" larger than the net frame size of the window. VPI shall not be responsible for any incorrect RO sizes.**

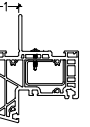

**VPI QUALITY WINDOWS**  
 3429E Terry Ave.  
 Spokane, WA 99202  
 www.vpiwindows.com

ENVISION NAIL FIN



ENV

**EXTERIOR  
ELEVATIONS**

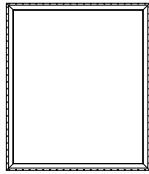

- 1. CW-PG40 (65 X 110) ENV FIXED WINDOW
- 2. CW-PG40 (72 X 108) ENV FIXED WINDOW
- 3. CW-PG65 (82 X 96) ENV FIXED WINDOW

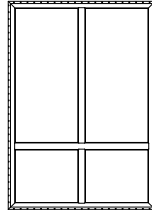

- 4. LC-PG45 (84 X 120) ENV 4 FIXED LITE WINDOW
- 5. CW-PG40 (84 X 120) ENV 4 FIXED LITE WINDOW

**INTERIOR  
ELEVATIONS**

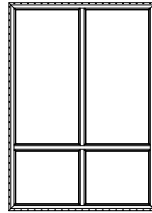
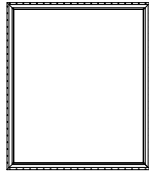

START DATE:	12/21/23
FINISH DATE:	12/21/23
CHECKED BY:	ENGINEERING
SCALE:	3/32"=1'
DWG BY:	BSP
QUOTE:	
REVISION:	